

H7 Family Trims

OPEN TRIMS

79

Pinhole Trim

Lamps: R20*

79P=Pinhole Trim - White

O.D = 8" (203mm)

Used In:

H7T

H27T

H7T-79
50W R20 SP 440 Lumens

Dia	FC	Work Plane
3'0"	15	4'6"
4'0"	7	6'6"
5'6"	4	8'6"
6'6"	3	10'6"
8'0"	2	12'6"
9'0"	2	14'6"

Work Plane is 2 1/2 ft above floor
Dia of circle is 50% of max
footcandles directly under fixture

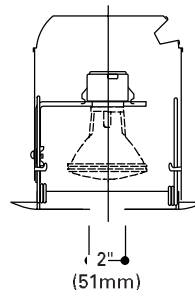

79 Pinhole

300

Open Trim - Socket

Supporting

Lamps: R30, PAR30, Par30L•

300P=Open Trim - White

O.D = 7 1/4" (184mm)

Used In:

H7ICT, H7ICAT, H7RICT, H7RICAT

H7ICTNB, H7ICATNB

H7UICT, H7UICAT

H7T-300
75W R30 SP 900 Lumens

Dia	FC	Work Plane
2'0"	75	4'6"
3'0"	36	6'6"
4'0"	21	8'6"
5'0"	14	10'6"
6'0"	10	12'6"
7'0"	7	14'6"

Work Plane is 2 1/2 ft above floor
Dia of circle is 50% of max
footcandles directly under fixture

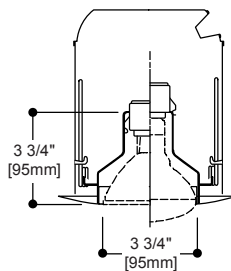

300 Open

301

Open Trim

Lamps: R30, BR30, PAR30*

301P=White Open Trim

301PB=Polished Brass Open Trim

O.D = 7 1/4" (184mm)

Used In:

H7T, H7RT

H27T, H27RT

H7T-301
75W R30 SP 900 Lumens

Dia	FC	Work Plane
2'0"	75	4'6"
3'0"	36	6'6"
4'0"	21	8'6"
5'0"	14	10'6"
6'0"	10	12'6"
7'0"	7	14'6"

Work Plane is 2 1/2 ft above floor
Dia of circle is 50% of max
footcandles directly under fixture

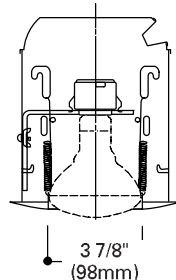

301 Open

327

Open Splay Trim

Lamps: R30, BR30, PAR30*

327=White Open Splay Trim with

Socket

Support

O.D = 7 3/4" (197mm)

Used In:

H7ICT, H7ICAT, H7RICT, H7RICAT

H7ICTNB, H7ICATNB

H7UICT, H7UICAT

H7T-327 75W PAR30FL 1100 Lumens			H7T-327 75W R30FL 900 Lumens		
Dia	FC	Work Plane	FC	Dia	Work Plane
3'0"	81	5'6"	15	6'0"	4'6"
4'0"	58	6'6"	11	7'0"	6'6"
5'0"	38	8'0"	7	8'0"	8'6"
6'0"	24	10'0"	4	10'0"	10'6"
7'0"	17	12'0"	3	12'0"	14'6"

Based on Bare Lamp Data
Work Plane is 2 1/2 ft above floor
Dia of circle is 50% of max footcandles directly under fixture

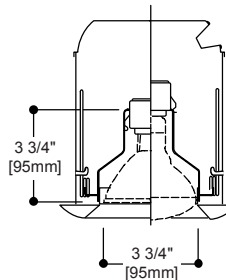

327 Splay

328

Open Splay Trim

Lamps: R30, BR30, PAR30*

328=White Open Splay Trim

O.D = 7 3/4" (197mm)

Used In:

H7ICT, H7ICAT, H7RICT, H7RICAT

H27ICT, H27ICAT, H27RICT

H27T, H27RT

H7T-328 75W PAR30FL 1100 Lumens			H7T-328 75W R30FL 900 Lumens		
Dia	FC	Work Plane	FC	Dia	Work Plane
3'0"	81	5'6"	15	6'0"	4'6"
4'0"	58	6'6"	11	7'0"	6'6"
5'0"	38	8'0"	7	8'0"	8'6"
6'0"	24	10'0"	4	10'0"	10'6"
7'0"	17	12'0"	3	12'0"	14'6"

Based on Bare Lamp Data
Work Plane is 2 1/2 ft above floor
Dia of circle is 50% of max footcandles directly under fixture

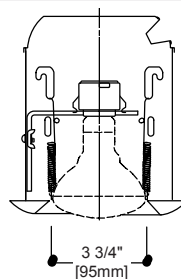

328 Splay

* Lamp Wattage and type vary with Housings.
Refer to individual housing sheets for specific wattage ratings

H7 Family Trims

OPEN TRIMS

401

Open Trim

Lamps: R40*

401AL=Aluminum Finish

Open Trim

401P=White Open Trim

401PB=Polished Brass Open Trim

O.D = 8" (203mm)

Used In:

H7T, H7RT

H7UICAT, H7UICAT

H7T-401 75W R40 SP 1900 Lumens			H7T-401 75W R40 FL 1900 Lumens		
Dia	FC	Work Plane	FC	Dia	
2'0"	270	4'6"	50	4'6"	
2'6"	129	6'6"	24	6'6"	
3'0"	76	8'6"	14	8'6"	
4'0"	50	10'6"	9	10'6"	
5'0"	35	12'6"	7	12'6"	
6'0"	26	14'6"	5	14'6"	

Work Plane is 2 1/2 ft above floor
Dia of circle is 50% of max footcandles directly under fixture

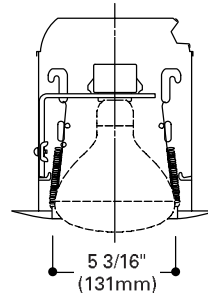

401 Open

428

Open Splay Trim

Lamps: R40*

428P=White Open Splay Trim

O.D = 7 3/4" (197mm)

Used In:

H7T, H7RT

H7UICAT, H7UICAT

H7T-428 75W R40 SP 1900 Lumens			H7T-428 75W R40 FL 1900 Lumens		
Dia	FC	Work Plane	FC	Dia	
2'0"	270	4'6"	50	4'6"	
2'6"	129	6'6"	24	6'6"	
3'0"	76	8'6"	14	8'6"	
4'0"	50	10'6"	9	10'6"	
5'0"	35	12'6"	7	12'6"	
6'0"	26	14'6"	5	14'6"	

Work Plane is 2 1/2 ft above floor
Dia of circle is 50% of max footcandles directly under fixture

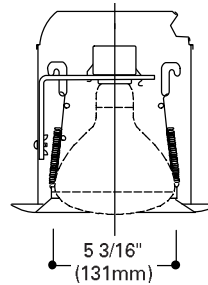

428 Open

* Lamp Wattage and type vary with Housings.
Refer to individual housing sheets for specific wattage ratings

Note: Specifications and Dimensions subject to change without notice.

Visit our web site at www.cooperlighting.com